

SKYLAKE™ DRY DAYPACK 18L

SEALLINE®

A lightweight, stowable waterproof dry daypack, the Skylake™ carries essentials on shorter excursions whether paddling, fishing or traveling. Features include a harness system for easy carrying, front stash pocket for quick access, and roll up design for compact stowing.

FEATURES

- 1 **LIGHTWEIGHT WATERPROOF** material and fully welded seam construction for confident protection
- 2 **DRYSEAL™ ROLL-TOP CLOSURE** for optimal, intuitive sealing
- 3 **REMOVABLE HARNESS SYSTEM** with lightly padded shoulder straps for comfortable carrying
- 4 **FRONT MESH STASH POCKET** for quick and easy stowing and retrieval on pack exterior
- 5 **ATTACHMENT POINT** for clipping on accessories

CONVENIENT ROLL & STOW DESIGN secured by front pocket strap for compact storage

LIGHT-COLORED INTERIOR for ease of identifying contents within

PRINTED ROLL-TOP INSTRUCTIONS on pack interior for reference in the field

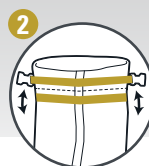

FEATURES & INSTRUCTIONS

ATTACH/ DETACH SHOULDER HARNESS

Your daypack comes with the shoulder harness attached. To detach it for travel or dry bag use, simply unthread webbing to detach and re-thread to re-attach.

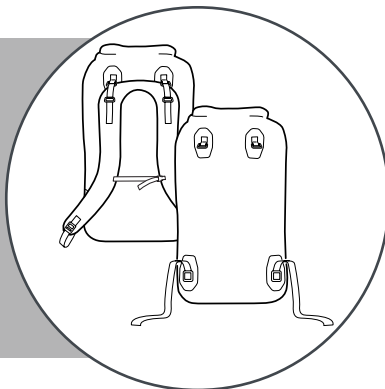

CLOSE & SEAL PACK

NOTE: Roll-top Instructions are also printed on the interior of your pack for reference in the field.

①

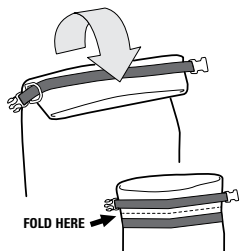

1. **FOLD** To properly close and seal pack, first ensure both black sealing strips are wrinkle-free. Fold the top over toward sealing strips, line up strips, and press together.

②

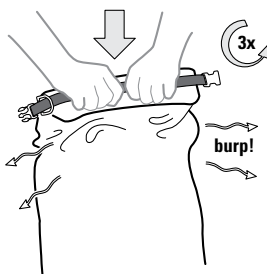

2. **BURP** Hold sealing strips firmly together and push down on the pack to 'burp' out trapped air. Fold and roll tightly at least twice until black strips are no longer visible.

③



3. **CLASP** Pull ends together in the opposite direction of the fold and connect buckle.

ROLL & STOW PACK

①

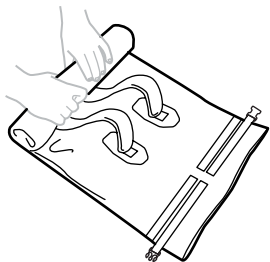

1. **ROLL** Lay pack down flat with shoulder straps facing up. Starting at the bottom, roll up tightly toward the top of the pack.

②

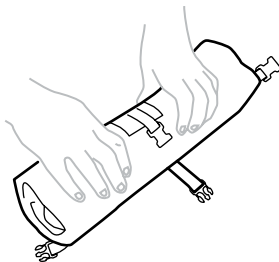

2. **SECURE** Lengthen the exterior pocket clip, wrap webbing around the rolled pack and connect to buckle.

③

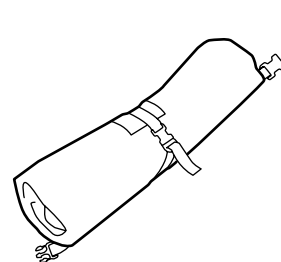

3. **STOW** Cinch down webbing to make your pack even more compact and stowable.

MORE INFO

DRY PACK CARE & USE

To substantially increase the life of dry packs, follow these guidelines:

- After each use, the pack should be cleaned and air dried
 - To clean, wash with a soapy brush and rinse
 - Store pack once completely dry, inside and out
 - When packing, pad items with hard, sharp corners to minimize wear on the fabric
 - Keep all insect repellents and solvents from making direct contact with dry packs.
- If contact occurs, wash the pack thoroughly.

NOTICE

No roll-down closure pack from any manufacturer is 100% waterproof when submerged. This pack is not suitable for protecting items such as optical, electrical or photographic equipment, as submersion or impact may do permanent damage. For such equipment, hard cases with O-ring seals are recommended to protect against impact damage and long-term submersion. SealLine® Dry Packs are intended to protect your equipment and belongings from rain, splash, and spray. They are not intended for submerged use.



LIMITED LIFETIME WARRANTY

For limited warranty information, please go to: seallinegear.com/warranty

FOR REPAIR OR WARRANTY SERVICE

Please contact our product service center:

U.S. 1-800-531-9531

CANADA 1-888-801-5335

ONLINE seallinegear.com/warranty

SEALLINE®

©2019 Cascade Designs, Inc.

4000 First Ave. S.

Seattle, WA 98134 U.S.A.

1-800-531-9531

seallinegear.com